



**VARILITE**

## **IMPORTANT PRODUCT INFORMATION**

# **USER MANUAL**

*(eBack™, Evolution Back™, and Evolution Back Deep™)*



***Important Note for Dealers:***

Please provide the User or Caregiver with this manual.

***Important Note for eBack, Evolution Back and Evolution Back Deep Users and Caregivers:***

Please keep this manual for future reference.

If you do not understand this instruction manual or if you have any questions, please contact VARILITE Customer Service at 800.827.4548 or 206.505.9500.



---

## **Table of Contents**

***This User Manual explains how to care for, maintain, and adjust your VARILITE back support.***

Warnings	pages 3-6
Thoracic Support Instructions	page 11
Operating Instructions	pages 7-10
Care and Maintenance	page 11
Warranty	page 12

***Important Note for Suppliers:*** Please provide the User or Caregiver with this manual.

***Important Note for VARILITE Back Support Users and Caregivers:*** Please keep this manual for future reference.

If you do not understand this *User Manual* or if you have any questions, please contact VARILITE Customer Service at 800.827.4548 or 206.505.9500.

## **WARNING**

TO AVOID INJURY, read, understand and follow all instructions and warnings in this manual before using your *VARILITE* back support.

There are hazards associated with the use of wheelchairs and adaptive equipment. If you misuse your wheelchair or your back support you can be seriously injured.

Installation and adjustment of your *VARILITE* back support should be performed only by an authorized dealer or qualified therapist. Improper installation or adjustment can result in equipment damage and serious injuries.

- Ensure that your *VARILITE* hardware is tightened and that the back support functions according to the operating instructions in this manual before using your wheelchair. If you are unable to check hardware tightness, please seek qualified assistance.
- Never use your wheelchair if any *VARILITE* hardware is missing, malfunctioning, or broken. Seek qualified assistance with any repairs or adjustments.



## **WARNING**

- Never exceed the weight capacity of the back support. Never perform weight training that causes you to exceed the weight capacity of the back support. If you exceed the recommended weight capacity you can damage equipment and be seriously injured.
- Never exceed the weight capacity of the wheelchair as specified by the wheelchair manufacturer. Never perform weight training that causes you to exceed the weight capacity of the wheelchair. If you exceed the recommended weight capacity you can damage equipment and be seriously injured.
- Never lift the wheelchair by the back support.
- Never use the back support without its cover. For your safety, *VARILITE* cushion covers are made with flame retardant materials.
- Never modify your *VARILITE* back support or use it in a way not described by this manual.
- Follow the instructions and warnings provided by the wheelchair manufacturer.

## **WARNING**

### **Wheelchair Compatibility**

*VARILITE* eBack, Evolution Back and Evolution Back Deep are designed to be compatible with most wheelchairs, noting the following exceptions:

The system can be used only with wheelchairs with cane diameters equal to 1 inch (25 mm) or less.

The system can be used only with wheelchairs with round canes.

Wheelchairs are not required to have stabilizer bars, provided the canes can maintain their position.

## ***Use in a Motor Vehicle***

**For eBack™ Tall, Evolution Back™ Tall and Evolution Back Deep™:**

### **WARNING**

This seating system has been dynamically tested and meets requirements of ANSI WC20/Vol4 and conforms to ISO 16840-4 for the safe use of seating devices for use in motor vehicles when used with a wheelchair base that complies with performance requirements of ANSI WC19 or ISO 7176-19.

A surrogate wheelchair base and Hybrid III Midsize Male ATD were used in the frontal impact test.

Any postural support devices and belts that have not been successfully tested in accordance with ANSI/RESNA WC18 or WC19 should not be relied upon as an occupant restraint in a vehicle.

For additional information regarding the use of seating systems in motor vehicles, refer to *Safe Use in a Motor Vehicle* provided with this system and at [www.varilite.com](http://www.varilite.com).

**For eBack™ Regular, and Evolution Back™ Regular:**

### **WARNING**

This seating system has not been dynamically tested and does not meet requirements of ANSI WC20/Vol4 or conform to ISO 16840-4 for the safe use of seating devices for use in motor vehicles. To avoid serious injury or death, do not use this seating system in a motor vehicle.

For additional information regarding the use of seating systems in motor vehicles, refer to *Safe Use in a Motor Vehicle* at [www.varilite.com](http://www.varilite.com).

## **Operating Instructions**

### Removing Back Support

1. Depress the Catch on each of the Upper Cane Clips. The Catches will stay open. **(Fig. 1)**
2. Lift the Shell straight up so the Pin Bars clear the Cane Clips. Back can be removed with one hand. **(Fig. 2)**



**Fig. 1**



**Fig. 2**



## **Installing Back Support**

1. Hold the back assembly so the Pin Bars are against the wheelchair canes, slightly above their respective Cane Clips. **(Fig. 3)**
2. Push the shell assembly downward so the Pin Bars are inserted in the Cane Clips, and the Upper Cane Clip clicks into place. *VARILITE* back support can be installed with one hand. **(Fig. 4)**



**Fig. 3**

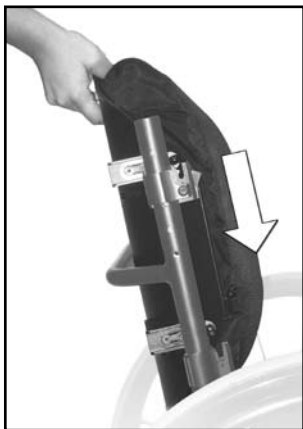

**Fig. 4**





### **Inflating Cushion**

1. To inflate cushion, remove load from cushion.
2. Open air valve by turning valve counterclockwise.
3. When cushion is fully inflated, close air valve by turning valve clockwise.

### **Adjusting Cushion**

1. To adjust the air level of the *VARILITE* back support, begin with the cushion fully inflated and the valve closed.
2. Position wheelchair user securely in wheelchair.
3. Turn the valve counterclockwise to open the valve and release air.
4. Close the valve when the air level that provides the support needed for the user's comfort and functionality is reached.

### **Removing Cushion**

1. Pull the cushion up to detach the cover from the shell.
2. Detach the Handle Flap from the hook patch on the inside of the Shell and pull the Handle Flap through the slots in the shell.

Note: Reverse the steps above to reattach the cushion.



## **Thoracic Support Instructions**

Your back system may include optional VARILITE PAL™ Swing-Away thoracic supports.

### **Operating Instructions:**

To initiate swing, depress the silver button and swing the pad bracket away from the user. *(Fig. 5)*

The bracket is locked into place when an auditory click is heard and the button is fully extended. *(Fig. 6)*

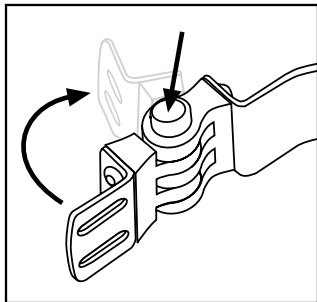

*Fig. 5*

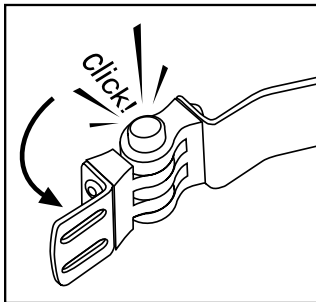

*Fig. 6*

### **Maintenance:**

- Wash pad covers in cold water. Air dry.
- Clean metal parts with soft cloth and isopropyl alcohol. Do not use soap-based products.
- NEVER oil the hinge mechanism.



## ***Care and Maintenance***

- The aluminum shell can be cleaned with soap and warm water. Do not saturate. Avoid getting water under the edge trim.
- The self-inflating cushion can be wiped with a damp cloth.
- The cushion cover can be removed and washed. Machine wash at 140° F (60° C). Air dry. For best result keep zipper closed.
- Never store your back support in conditions of extreme heat or exposure to direct sunlight for long periods of time.
- Never store sharp or heavy objects on top of your back cushion.
- Once a week, leave valve open overnight, allowing cushion to fully inflate in an unloaded state. Turn valve counterclockwise to open. Re-adjust cushion before next use.



---

## **Warranty**

*VARILITE's Warranty can be found in the Installation Instructions provided with this system and on [www.varilite.com](http://www.varilite.com)*

*Be sure to complete the Product Registration form that came with this back support, or available online at: [http://www.varilite.com/forms\\_warrantyreg.aspx](http://www.varilite.com/forms_warrantyreg.aspx)*

**VARILITE**  
4000 1st Ave. S  
Seattle, WA 98134  
1-800-827-4548  
[www.varilite.com](http://www.varilite.com)

**Authorized Representative:**  
Cascade Designs, Limited  
Dwyer Road, Midleton, Co. Cork  
Republic of Ireland